

Toptan 12 V olmayan dokunmatik kapı çıkış açma düğmesi DH-K810



- Dokunmasız / Dokunmasız Çıkış Sensörü (Dağınık Algılama)
- Optik / Kızılötesi Teknolojisi
- IP-55 Giriş Koruması / SUS 304 Paslanmaz çelik Levha
- Kullanıcı dostu (Sağlıklı koruma)
- Bulaşıcı hastalıklardan arındırılmış
- Algılama aralığı: 0.1 ~ 10 cm
- Uygulama: Kapı / Kapı / Çıkış / Otomasyon kontrolü
- Yüksek röle kuru kontak kapasitesi (3A / AC120V, DC30V)
- Normalde açık / Normalde kapalı / Ortak röle çıkışı
- Sensör bekleme veya yaklaşma için çift ledli göstergeler:
(1) Sensör Bekleme: MAVİ LED AÇIK
(2) Sensöre 10 cm'de yaklaşan ziyaretçiler: KIRMIZI LED AÇIK

Daha fotoğraflar

LED Indicator



A: Black/PC Lens
B: Round Shape LED Indicator

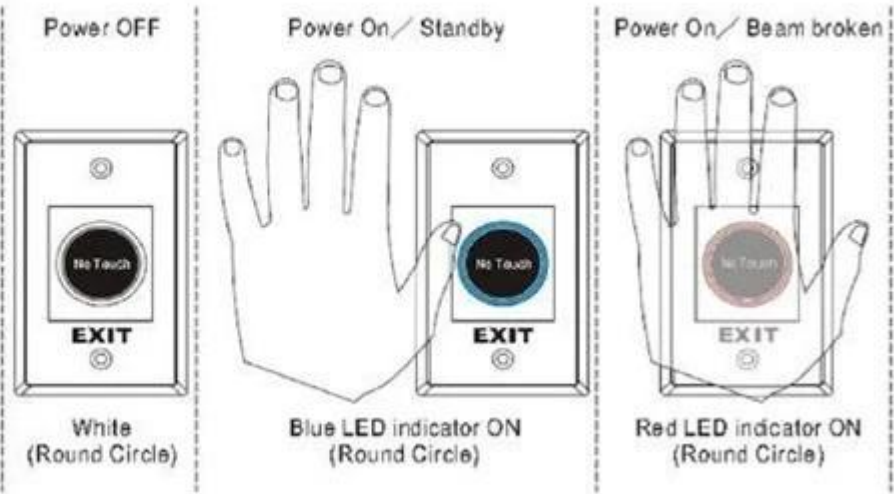

Sensing Range



Installation

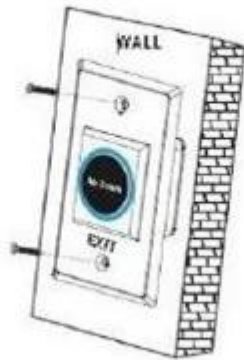

Red LED Indicator:
Power ON (Standby)



Green LED Indicator:
Power ON (Triggered)



Blue LED Indicator:
Power ON (Standby)



Red LED Indicator:
Power ON (Triggered)



bizim şirket

ABOUT US COMPANY INTRODUCTION

UDOHOW Electronics Co., Limited is a high-tech enterprise located in Guangdong Province, China. We're one of the leading manufacturers specialized in Intelligent Locks and Access Control Products including: Hotel Locks, Fingerprint Locks, Keypad Locks, Cabinets Locks, Electric Locks, Exit Switches and other related security access control products.

Our products have received good comments and trust of customers by superior quality, advanced innovation and considerate service.

+ View More



FACTORY / WORKSHOP / EXHIBITION



bizim sertifikalar

OUR CERTIFICATE



Biye Ulaşın

CONTACT US



Sincerely for your service

You are welcome to come to consult

Contact: Winnie Liang

Cellphone/Wechat/Whatsapp: +86 13602510930

Skype: udohow1

Email: info@udohow.com

Web: www.udohow.com

Click Back Home