

Zinc Alloyed mechanical keypad door lock DH8801



Attribute	Value
Material	Zinc alloy
password type	4-7 number
Appearance	pearl chrome, imitation
Door depth	30-70mm
Application scope	wooden doors, metal doors
Size	142*42*21mm
Working temperature	-20°C - 60°C
Working humidity	0%-95%



Scope Of Application



Material: Zinc Alloy

The shaft is made of hard steel, it is applicable for different thickness of door after adjusting with spring.



Keystroke function: 14 buttons, including 10 number keystroke and 4 letter keystroke.

Special key—button “C”, eliminate misinput, easily use.

Numerical key—choose 4-7 buttons to set the password in 13 keystroke except button “C”.

Change code function: basic on the customers' need , one should change password, 7 buttons most one time, but not overlap.

Security function: exactitude design, preciseness structure, mechanism motion. with strict trial ,it can still work normally after 50000 times opening, Possess security and secrecy.



**Product has the function of path
constant open and indoor close lock**

Official Accessories

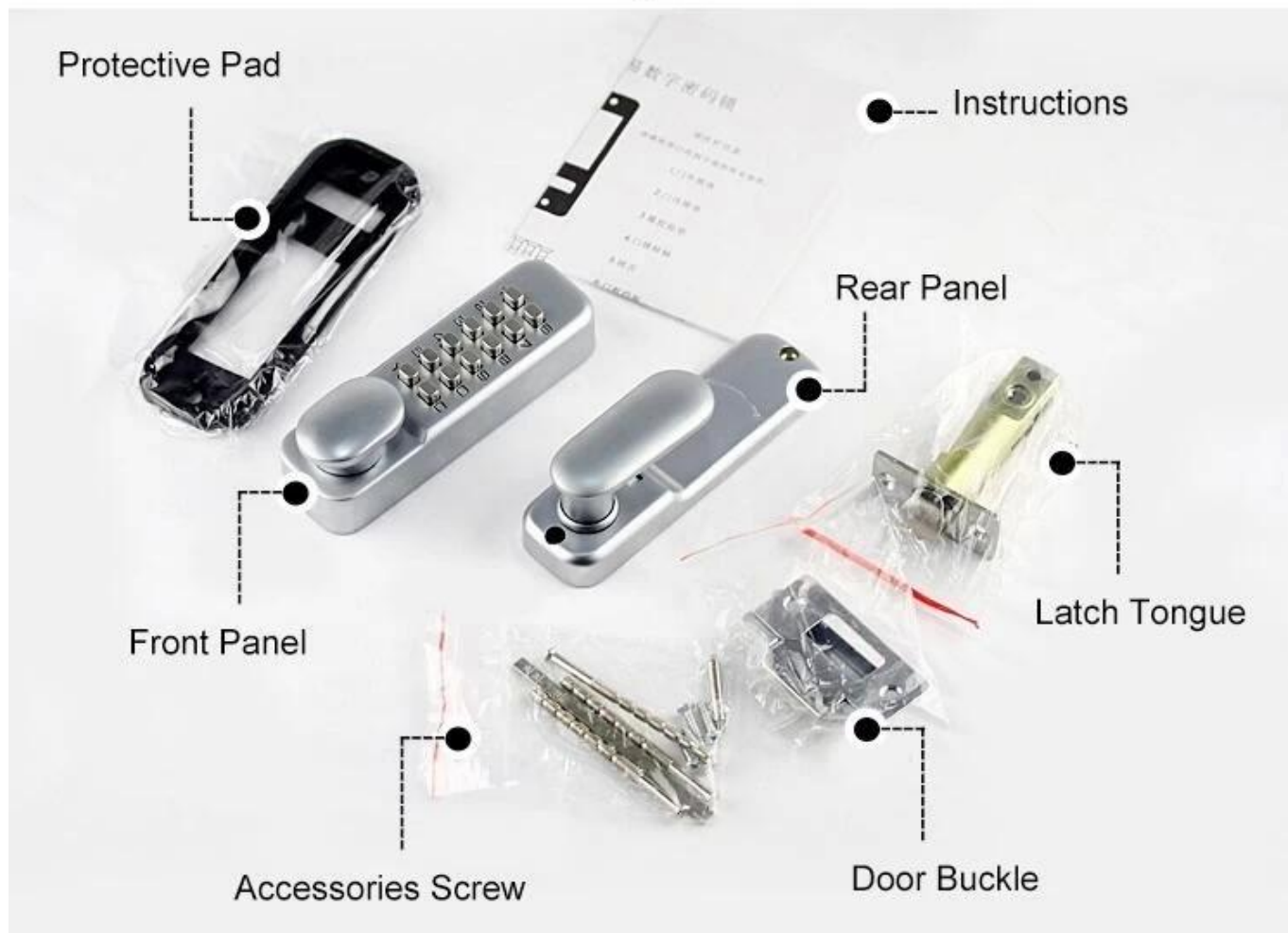

CONTACT US



Sincerely for your service

You are welcome to come to consult

Contact: Winnie Liang

Cellphone/Wechat/Whatsapp: +86 13602510930

Skype: udohow1

Email: info@udohow.com

Web: www.udohow.com

Click Back Home