

## Top Quality Zinc Alloyed Mechanical Password Door Lock DH8805

Model Number:DH8805

Color:Silver

Material:Zinc alloy

Unlock ways:Code

Latch:Single latch

Weight:1.25KG

Door thickness requirement:> 40mm





## How to change code of the 2th Generation lock

- 1.find the dot on the circle
- 2.Turn the dot toward the number  
for example 14569,just turn the dot to  
the number 14569
- 3.The new code is 14569





Home Door



Garage Door



Office



Classroom



Storeroom



Safety BOX



Attribute	Value
Material	Zinc alloy
password type	4-7 number
Appearance	pearl chrome, imitation
Door depth	30-70mm
Application scope	wooden doors, metal doors
Size	142*42*21mm
Working temperature	-20°C - 60°C
Working humidity	0%-95%



## Scope Of Application

# Official Accessories

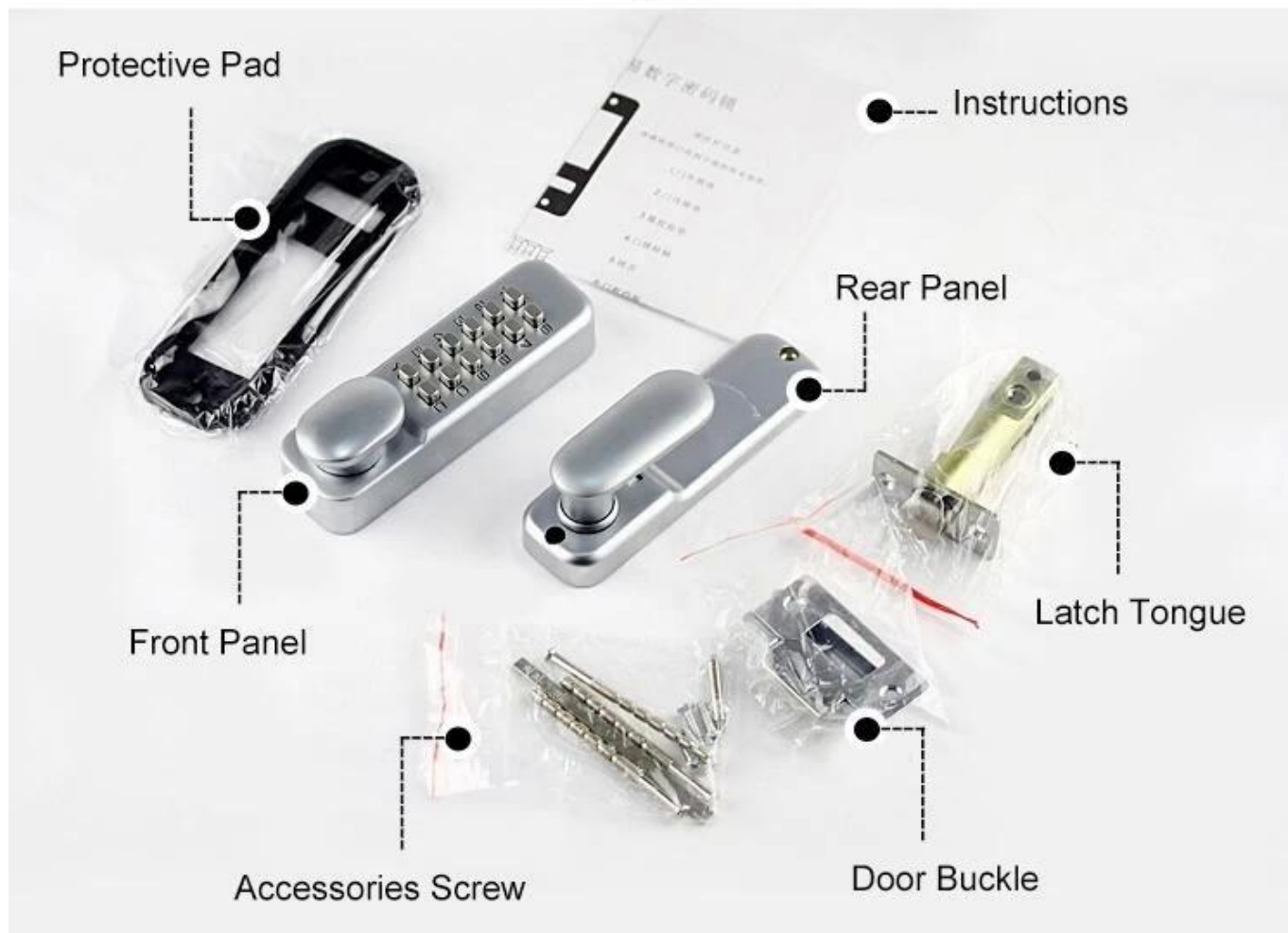

**CONTACT US**



**Sincerely for your service**

You are welcome to come to consult

**Contact:** Winnie Liang

**Cellphone/Wechat/Whatsapp:** +86 13602510930

**Skype:** udohow1

**Email:** info@udohow.com

**Web:** www.udohow.com

**Click Back Home**