

Wholesale 12V Infrared [Exit Button](#) No Touch Door Open Switch for Access Control



- No touch / Touch free Exit Sensor (Diffused Detection)
 - Optical / Infrared Technology
 - IP-55 Ingress Protection / SUS 304 Stainless steel Plate
 - User friendly (Healthy protection)
 - Free from contagious diseases spread
 - Detection range: 0.1 ~ 10 cm
 - Application: Gate/Door/Exit/Automation control
 - High capacity of relay dry contact (3A/AC120V,DC30V)
 - Normally open/Normally close/Common relay output
 - Twin led indicators for sensor standby or approached :
- (1) Sensor Standby: BLUE LED ON
(2) Visitors whom approached to the sensor in 10 cm : RED LED ON

More photos



udohow.en.alibaba.com



LED Indicator



A: Black/PC Lens
B: Round Shape LED Indicator

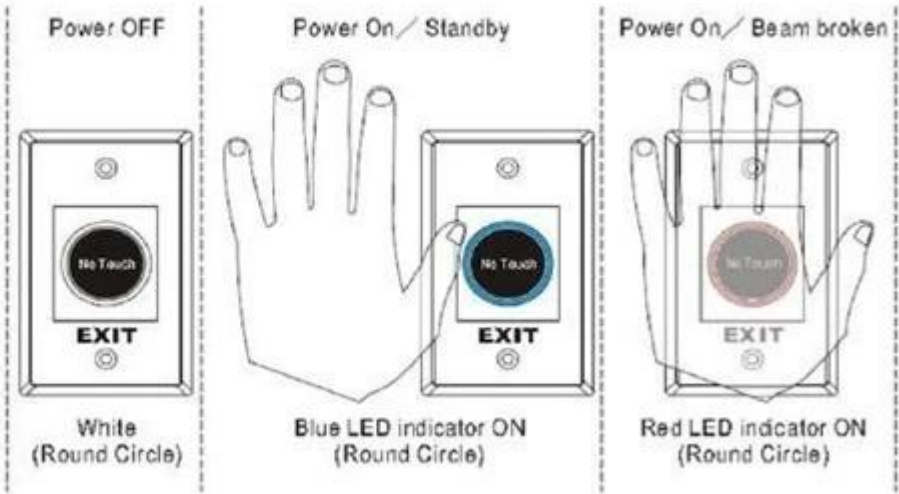

Sensing Range

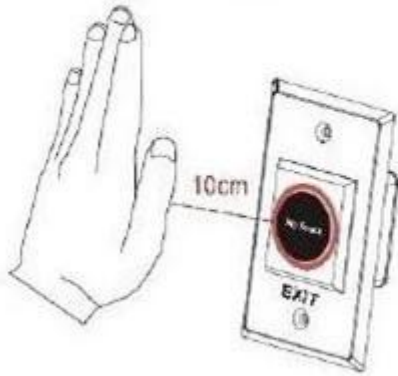

Installation

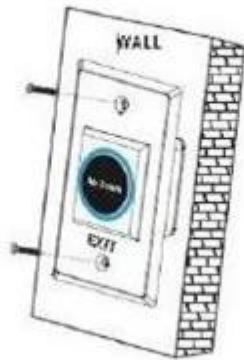

Red LED Indicator:
Power ON (Standby)



Green LED Indicator:
Power ON (Triggered)



Blue LED Indicator:
Power ON (Standby)



Red LED Indicator:
Power ON (Triggered)



Our company

ABOUT US COMPANY INTRODUCTION

UDOHOW Electronics Co., Limited is a high-tech enterprise located in Guangdong Province, China. We're one of the leading manufacturers specialized in Intelligent Locks and Access Control Products including: Hotel Locks, Fingerprint Locks, Keypad Locks, Cabinets Locks, Electric Locks, Exit Switches and other related security access control products.

Our products have received good comments and trust of customers by superior quality, advanced innovation and considerate service.

[+ View More](#)



FACTORY / WORKSHOP / EXHIBITION



Our certificates

OUR CERTIFICATE



Contact us

CONTACT US



Sincerely for your service

You are welcome to come to consult

Contact: Winnie Liang

Cellphone/Wechat/Whatsapp: +86 13602510930

Skype: udohow1

Email: info@udohow.com

Web: www.udohow.com

Click Back Home