

Ang bultuhang 12V non touch door exit button na DH-K810



- Walang touch / Touch libreng Exit Sensor (Nakakalat na Detection)
- Teknikal na Optical / Infrared
- IP-55 Ingress Protection / SUS 304 Hindi kinakalawang na asero na Plato
- Gumagamit ng friendly (Proteksyon ng malusog)
- Libre mula sa nakakahawang sakit na kumakalat
- Saklaw ng pagtuklas: 0.1 ~ 10 cm
- Application: Gate / Door / Exit / control ng automation
- Mataas na kapasidad ng relay dry contact (3A / AC120V, DC30V)
- Karaniwan na bukas / Karaniwan na malapit / Karaniwan na output ng relay
- Ang twin humantong mga tagapagpahiwatig para sa sensor ng standby o lumapit:
(1) Sensor Standby: BLUE LED ON
(2) Ang mga bisita na lumapit sa sensor sa 10 cm: RED LED ON

Marami pa mga larawan

LED Indicator



A: Black/PC Lens
B: Round Shape LED Indicator

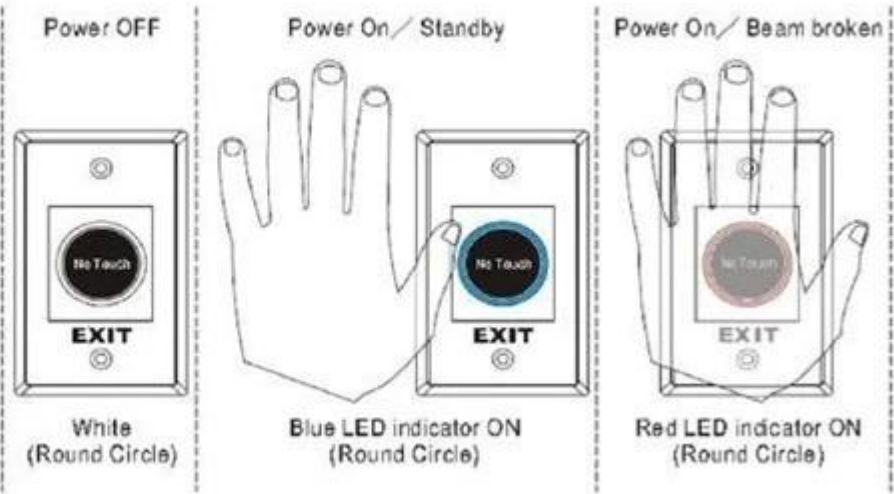

Sensing Range



Installation



Red LED Indicator:
Power ON (Standby)



Green LED Indicator:
Power ON (Triggered)



Blue LED Indicator:
Power ON (Standby)



Red LED Indicator:
Power ON (Triggered)



Kami kumpanya

ABOUT US COMPANY INTRODUCTION

UDOHOW Electronics Co., Limited is a high-tech enterprise located in Guangdong Province, China. We're one of the leading manufacturers specialized in Intelligent Locks and Access Control Products including: Hotel Locks, Fingerprint Locks, Keypad Locks, Cabinets Locks, Electric Locks, Exit Switches and other related security access control products.

Our products have received good comments and trust of customers by superior quality, advanced innovation and considerate service.

[+ View More](#)



FACTORY / WORKSHOP / EXHIBITION



Kami mga sertipiko

OUR CERTIFICATE



Makipag-ugnayan sa amin

CONTACT US



Sincerely for your service

You are welcome to come to consult

Contact: Winnie Liang

Cellphone/Wechat/Whatsapp: +86 13602510930

Skype: udohow1

Email: info@udohow.com

Web: www.udohow.com

Click Back Home