

Bultuhang 12V Infrared [Lumabas na Button](#) Walang Touch Door Open Switch para sa Access Control



- Walang touch / Touch libreng Exit Sensor (Diffused Detection)
- Teknikal na Optical / Infrared
- Proteksyon ng IP-55 Ingress / SUS 304 Platong hindi kinakalawang na asero
- Magiliw ng gumagamit (Malusog na proteksyon)
- Malaya mula sa mga nakakahawang sakit na kumalat
- Saklaw ng pagtuklas: 0.1 ~ 10 cm
- Application: Kontrol sa Gate / Door / Exit / Automation
- Mataas na kapasidad ng relay dry contact (3A / AC120V, DC30V)
- Karaniwang bukas / Karaniwan malapit / Karaniwang output ng relay
- Mga tagapagpahiwatig na pinangunahan ng kambal para sa pag-standby ng sensor o paglapit:
(1) Sensor Standby: BLUE LED ON
(2) Mga bisita na lumapit sa sensor sa 10 cm: RED LED ON

Dagdag pamga larawan



udohow.en.alibaba.com



LED Indicator



A: Black/PC Lens
B: Round Shape LED Indicator

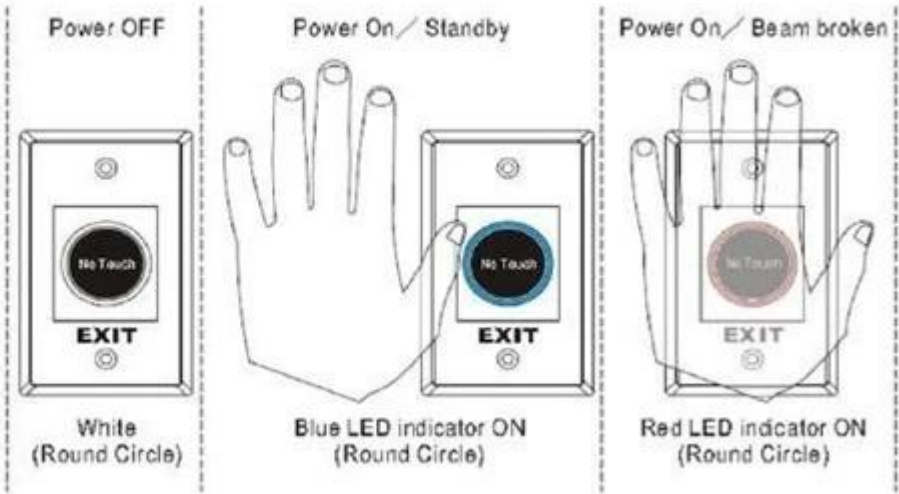

Sensing Range

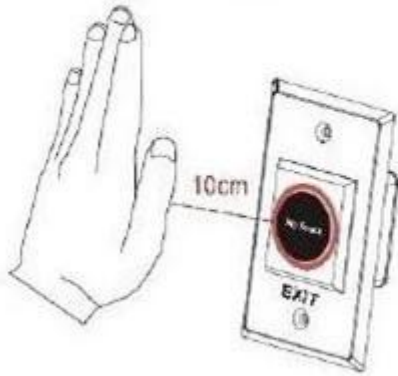

Installation

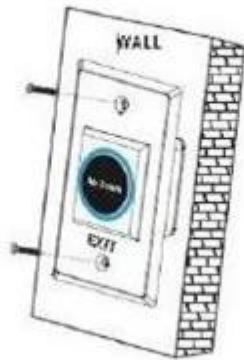

Red LED Indicator:
Power ON (Standby)



Green LED Indicator:
Power ON (Triggered)



Blue LED Indicator:
Power ON (Standby)



Red LED Indicator:
Power ON (Triggered)



Ang amingkumpanya

ABOUT US COMPANY INTRODUCTION

UDOHOW Electronics Co., Limited is a high-tech enterprise located in Guangdong Province, China. We're one of the leading manufacturers specialized in Intelligent Locks and Access Control Products including: Hotel Locks, Fingerprint Locks, Keypad Locks, Cabinets Locks, Electric Locks, Exit Switches and other related security access control products.

Our products have received good comments and trust of customers by superior quality, advanced innovation and considerate service.

[+ View More](#)



FACTORY / WORKSHOP / EXHIBITION



Ang amingmga sertipiko

OUR CERTIFICATE



Makipag-ugnayan sa amin

CONTACT US



Sincerely for your service

You are welcome to come to consult

Contact: Winnie Liang

Cellphone/Wechat/Whatsapp: +86 13602510930

Skype: udohow1

Email: info@udohow.com

Web: www.udohow.com

Click Back Home