

Pulsante di sblocco uscita porta esterna non touch 12V-DH810



- Sensore di uscita senza tocco / tocco libero (rilevamento diffuso)
- Tecnologia ottica / infrarossa
- Piastra di protezione IP-55 / SUS 304 in acciaio inossidabile
- Facile da usare (protezione salutare)
- Privo di diffusione di malattie contagiose
- Campo di rilevamento: 0,1 ~ 10 cm
- Applicazione: controllo cancello / porta / uscita / automazione
- Alta capacità del contatto a secco del relè (3A / AC120V, DC30V)
- Uscita relè normalmente aperta / normalmente chiusa / comune
- Indicatori a doppio led per sensore in standby o avvicinati:
 - (1) Standby sensore: LED BLU acceso
 - (2) Visitatori che si sono avvicinati al sensore in 10 cm: LED ROSSO acceso

Di Più fotografie

LED Indicator



A: Black/PC Lens
B: Round Shape LED Indicator

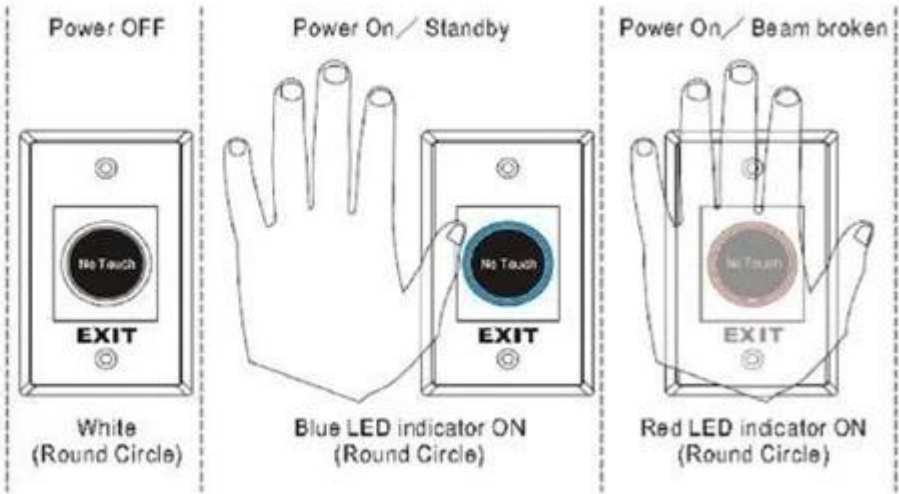

Sensing Range



Installation

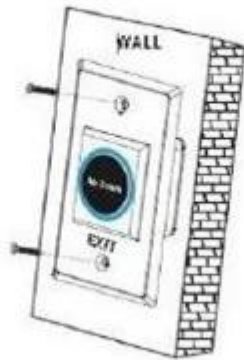

Red LED Indicator:
Power ON (Standby)



Green LED Indicator:
Power ON (Triggered)



Blue LED Indicator:
Power ON (Standby)



Red LED Indicator:
Power ON (Triggered)



Nostro azienda

ABOUT US COMPANY INTRODUCTION

UDOHOW Electronics Co., Limited is a high-tech enterprise located in Guangdong Province, China. We're one of the leading manufacturers specialized in Intelligent Locks and Access Control Products including: Hotel Locks, Fingerprint Locks, Keypad Locks, Cabinets Locks, Electric Locks, Exit Switches and other related security access control products.

Our products have received good comments and trust of customers by superior quality, advanced innovation and considerate service.

[+ View More](#)



FACTORY / WORKSHOP / EXHIBITION



Nostro certificati

OUR CERTIFICATE



Contattaci

CONTACT US



Sincerely for your service

You are welcome to come to consult

Contact: Winnie Liang

Cellphone/Wechat/Whatsapp: +86 13602510930

Skype: udohow1

Email: info@udohow.com

Web: www.udohow.com

Click Back Home