

## Wholesale 12V non touch door exit release button DH-K810



- No touch / Touch free Exit Sensor (Diffused Detection)
- Optical / Infrared Technology
- IP-55 Ingress Protection / SUS 304 Stainless steel Plate
- User friendly (Healthy protection)
- Free from contagious diseases spread
- Detection range: 0.1 ~ 10 cm
- Application: Gate/Door/Exit/Automation control
- High capacity of relay dry contact (3A/AC120V,DC30V)
- Normally open/Normally close/Common relay output
- Twin led indicators for sensor standby or approached :
- (1) Sensor Standby: BLUE LED ON
- (2) Visitors whom approached to the sensor in 10 cm : RED LED ON

**More photos**

## LED Indicator



A: Black/PC Lens  
B: Round Shape LED Indicator

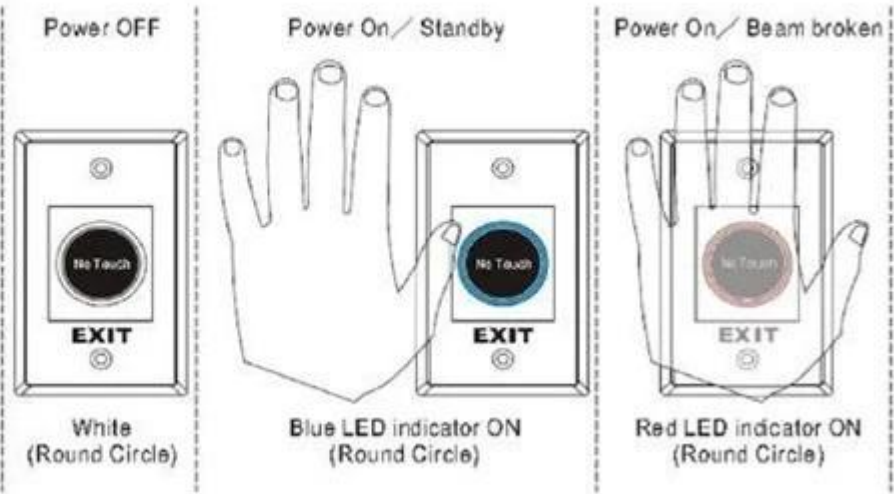

## Sensing Range



## Installation

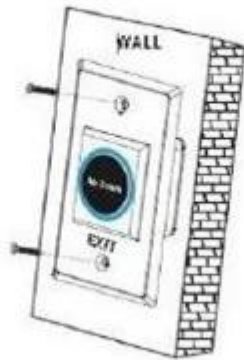

Red LED Indicator:  
Power ON (Standby)



Green LED Indicator:  
Power ON (Triggered)



Blue LED Indicator:  
Power ON (Standby)



Red LED Indicator:  
Power ON (Triggered)



# Our company

## ABOUT US COMPANY INTRODUCTION

UDOHOW Electronics Co., Limited is a high-tech enterprise located in Guangdong Province, China. We're one of the leading manufacturers specialized in Intelligent Locks and Access Control Products including: Hotel Locks, Fingerprint Locks, Keypad Locks, Cabinets Locks, Electric Locks, Exit Switches and other related security access control products.

Our products have received good comments and trust of customers by superior quality, advanced innovation and considerate service.

[+ View More](#)



## FACTORY / WORKSHOP / EXHIBITION



# Our certificates

## OUR CERTIFICATE



# Contact us

**CONTACT US**



## **Sincerely for your service**

**You are welcome to come to consult**

**Contact:** Winnie Liang

**Cellphone/Wechat/Whatsapp:** +86 13602510930

**Skype:** udohow1

**Email:** info@udohow.com

**Web:** www.udohow.com

**Click Back Home**