

## Vente en gros 12V non tactile bouton de libération de sortie de porte DH-K810



- Capteur de sortie sans contact / sans contact (détection diffuse)
- Technologie optique / infrarouge
- Protection IP-55 / plaque en acier inoxydable SUS 304
- Convivial (protection saine)
- Indemne de propagation de maladies contagieuses
- Plage de détection: 0,1 ~ 10 cm
- Application: portail / porte / sortie / contrôle d'automatisation
- Grande capacité de contact sec de relais (3A / AC120V, DC30V)
- Sortie relais normalement ouverte / normalement fermée / commune
- Indicateurs à double led pour veille du capteur ou approche:  
(1) Veille du capteur: LED BLEUE ALLUMÉE  
(2) Visiteurs qui se sont approchés du capteur en 10 cm: LED ROUGE ALLUMÉE

### Plus Photos

# LED Indicator



A: Black/PC Lens  
B: Round Shape LED Indicator

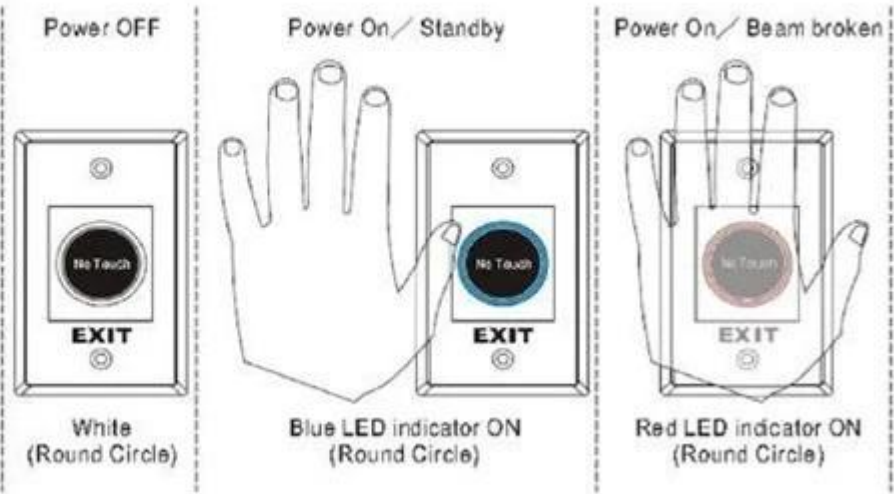

## Sensing Range



## Installation

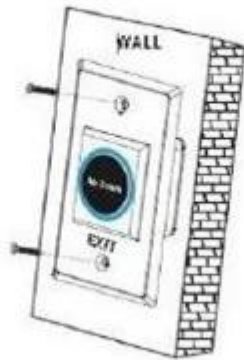

Red LED Indicator:  
Power ON (Standby)



Green LED Indicator:  
Power ON (Triggered)



Blue LED Indicator:  
Power ON (Standby)



Red LED Indicator:  
Power ON (Triggered)





# Notre compagnie

## ABOUT US COMPANY INTRODUCTION

UDOHOW Electronics Co., Limited is a high-tech enterprise located in Guangdong Province, China. We're one of the leading manufacturers specialized in Intelligent Locks and Access Control Products including: Hotel Locks, Fingerprint Locks, Keypad Locks, Cabinets Locks, Electric Locks, Exit Switches and other related security access control products.

Our products have received good comments and trust of customers by superior quality, advanced innovation and considerate service.

[+ View More](#)



## FACTORY / WORKSHOP / EXHIBITION



# Notre certificats

## OUR CERTIFICATE



# Nous contacter

**CONTACT US**



## **Sincerely for your service**

**You are welcome to come to consult**

**Contact:** Winnie Liang

**Cellphone/Wechat/Whatsapp:** +86 13602510930

**Skype:** udohow1

**Email:** info@udohow.com

**Web:** www.udohow.com

**Click Back Home**