

Vente en gros 12VInfrarouge [Bouton de sortie](#) Interrupteur d'ouverture de porte sans contact pour le contrôle d'accès



- Capteur de sortie sans contact / sans contact (détection diffuse)
- Technologie optique / infrarouge
- Indice de protection IP-55 / Plaque en acier inoxydable SUS 304
- Convivial (protection saine)
- Sans propagation de maladies contagieuses
- Plage de détection: 0,1 ~ 10 cm
- Application: contrôle de porte / porte / sortie / automatisation
- Haute capacité de contact sec de relais (3A / AC120V, DC30V)
- Sortie de relais normalement ouverte / normalement fermée / commune
- Deux voyants LED pour le capteur en attente ou approché:
(1) Capteur en veille: LED BLEUE ALLUMÉE
(2) Visiteurs qui se sont approchés du capteur en 10 cm: LED ROUGE ALLUMÉE

PlusPhotos



udohow.en.alibaba.com



LED Indicator



A: Black/PC Lens
B: Round Shape LED Indicator

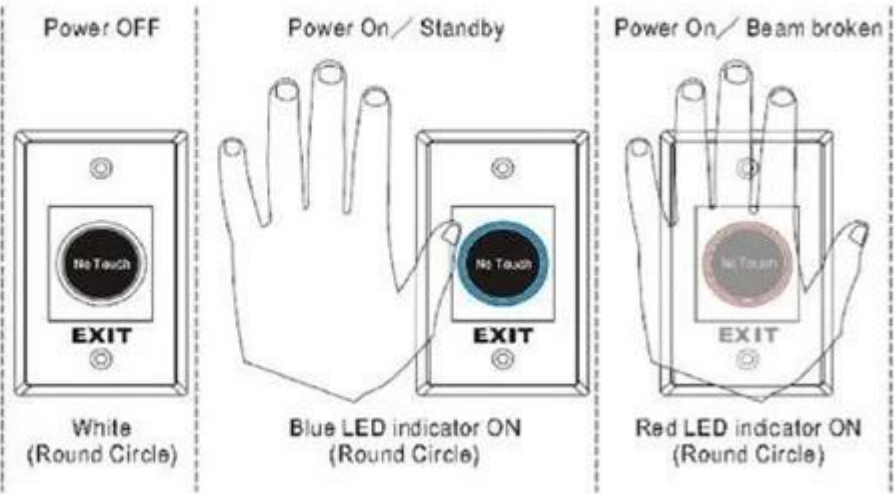

Sensing Range



Installation



Red LED Indicator:
Power ON (Standby)



Green LED Indicator:
Power ON (Triggered)



Blue LED Indicator:
Power ON (Standby)



Red LED Indicator:
Power ON (Triggered)



Notrecompagnie

ABOUT US COMPANY INTRODUCTION

UDOHOW Electronics Co., Limited is a high-tech enterprise located in Guangdong Province, China. We're one of the leading manufacturers specialized in Intelligent Locks and Access Control Products including: Hotel Locks, Fingerprint Locks, Keypad Locks, Cabinets Locks, Electric Locks, Exit Switches and other related security access control products.

Our products have received good comments and trust of customers by superior quality, advanced innovation and considerate service.

[+ View More](#)



FACTORY / WORKSHOP / EXHIBITION



Notrecertificats

OUR CERTIFICATE



Nous contacter

CONTACT US



Sincerely for your service

You are welcome to come to consult

Contact: Winnie Liang

Cellphone/Wechat/Whatsapp: +86 13602510930

Skype: udohow1

Email: info@udohow.com

Web: www.udohow.com

Click Back Home