

## Botón de liberación de salida de puerta no táctil de 12V al por mayor DH-K810



- Sensor de salida sin contacto / sin contacto (detección difusa)
- Tecnología óptica / infrarroja
- Protección de entrada IP-55 / Placa de acero inoxidable SUS 304
- Fácil de usar (protección saludable)
- Libre de enfermedades contagiosas diseminadas
- Rango de detección: 0.1 ~ 10 cm
- Aplicación: control de puerta / puerta / salida / automatización
- Alta capacidad de contacto seco de relé (3A / AC120V, DC30V)
- Normalmente abierto / Normalmente cerrado / Salida de relé común
- Indicadores LED gemelos para sensores en espera o aproximados:  
(1) Sensor en espera: LED AZUL ENCENDIDO  
(2) Visitantes que se acercaron al sensor en 10 cm: LED ROJO ENCENDIDO

### Más fotos

# LED Indicator



A: Black/PC Lens  
B: Round Shape LED Indicator

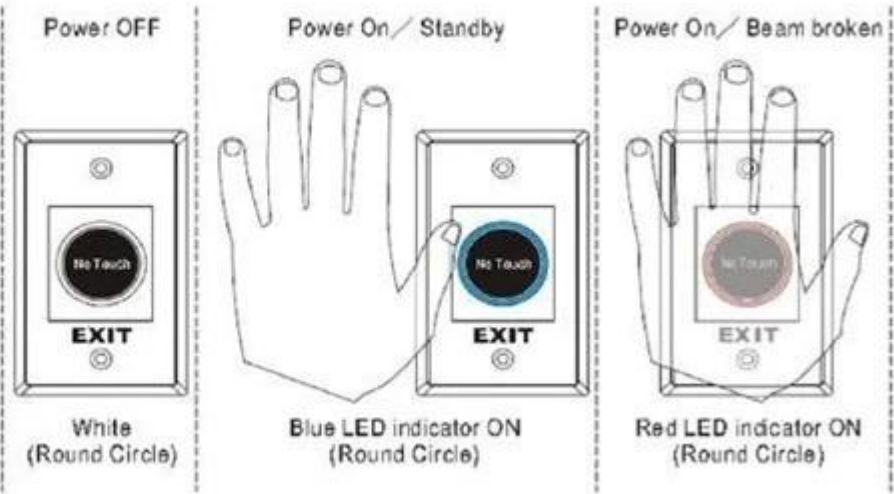

## Sensing Range



## Installation



Red LED Indicator:  
Power ON (Standby)



Green LED Indicator:  
Power ON (Triggered)



Blue LED Indicator:  
Power ON (Standby)



Red LED Indicator:  
Power ON (Triggered)



# Nuestra empresa

## ABOUT US COMPANY INTRODUCTION

UDOHOW Electronics Co., Limited is a high-tech enterprise located in Guangdong Province, China. We're one of the leading manufacturers specialized in Intelligent Locks and Access Control Products including: Hotel Locks, Fingerprint Locks, Keypad Locks, Cabinets Locks, Electric Locks, Exit Switches and other related security access control products.

Our products have received good comments and trust of customers by superior quality, advanced innovation and considerate service.

[+ View More](#)



## FACTORY / WORKSHOP / EXHIBITION



# Nuestra certificados

## OUR CERTIFICATE



# Contáctenos

**CONTACT US**



## **Sincerely for your service**

**You are welcome to come to consult**

**Contact:** Winnie Liang

**Cellphone/Wechat/Whatsapp:** +86 13602510930

**Skype:** udohow1

**Email:** info@udohow.com

**Web:** www.udohow.com

**Click Back Home**