

Venta al por mayor 12V Infrarred [Botón de salida](#) Interruptor de apertura de puerta sin contacto para control de acceso



- Sensor de salida sin contacto / sin contacto (detección difusa)
- Tecnología óptica / infrarroja
- Protección de ingreso IP-55 / Placa de acero inoxidable SUS 304
- Fácil de usar (protección saludable)
- Libre de propagación de enfermedades contagiosas
- Rango de detección: 0,1 ~ 10 cm
- Aplicación: Control de puerta / puerta / salida / automatización
- Alta capacidad de relé de contacto seco (3A / AC120V, DC30V)
- Salida de relé normalmente abierta / normalmente cerrada / común
- Indicadores LED dobles para sensor en espera o aproximado:  
(1) Sensor en espera: LED AZUL ENCENDIDO  
(2) Visitantes que se acercaron al sensor en 10 cm: LED ROJO ENCENDIDO

**Másfotos**



[udohow.en.alibaba.com](http://udohow.en.alibaba.com)



# LED Indicator



A: Black/PC Lens  
B: Round Shape LED Indicator

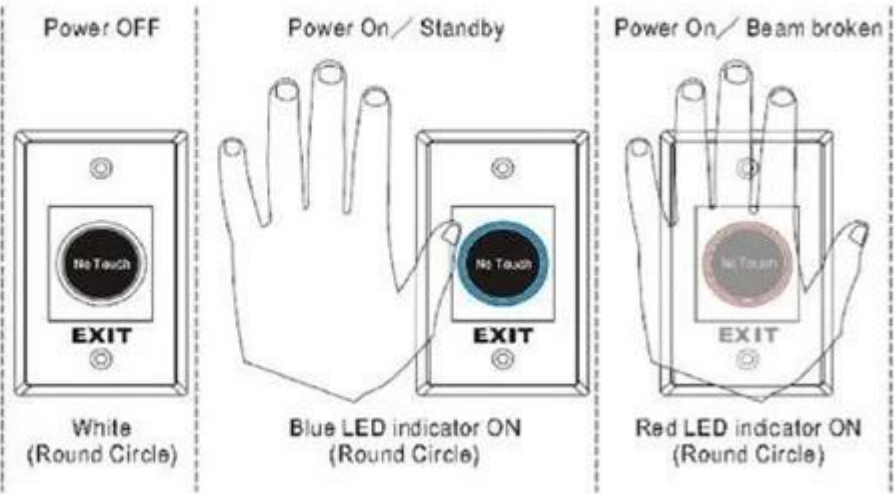

## Sensing Range



## Installation



Red LED Indicator:  
Power ON (Standby)



Green LED Indicator:  
Power ON (Triggered)



Blue LED Indicator:  
Power ON (Standby)



Red LED Indicator:  
Power ON (Triggered)



# Nuestroempresa

## ABOUT US COMPANY INTRODUCTION

UDOHOW Electronics Co., Limited is a high-tech enterprise located in Guangdong Province, China. We're one of the leading manufacturers specialized in Intelligent Locks and Access Control Products including: Hotel Locks, Fingerprint Locks, Keypad Locks, Cabinets Locks, Electric Locks, Exit Switches and other related security access control products.

Our products have received good comments and trust of customers by superior quality, advanced innovation and considerate service.

[+ View More](#)



## FACTORY / WORKSHOP / EXHIBITION



## Nuestrocertificados

### OUR CERTIFICATE



## Contáctenos

**CONTACT US**



## **Sincerely for your service**

**You are welcome to come to consult**

**Contact:** Winnie Liang

**Cellphone/Wechat/Whatsapp:** +86 13602510930

**Skype:** udohow1

**Email:** info@udohow.com

**Web:** www.udohow.com

**Click Back Home**