

Großhandel 12VInfrarot [Beenden Sie die Taste](#) No Touch Door Open-Schalter für die Zugangskontrolle



- Kein berührungsloser Ausgangssensor (diffuse Erkennung)
- Optische / Infrarot-Technologie
- IP-55 Ingress Protection / SUS 304 Edelstahlplatte
- Benutzerfreundlich (gesunder Schutz)
- Frei von ansteckenden Krankheiten
- Erfassungsbereich: 0,1 ~ 10 cm
- Anwendung: Tor- / Tür- / Ausgangs- / Automatisierungssteuerung
- Hohe Kapazität des Trockenkontakts des Relais (3A / AC120V, DC30V)
- Normalerweise offen / normalerweise geschlossen / gemeinsamer Relaisausgang
- Doppel-LED-Anzeigen für Sensor-Standby oder Annäherung:
(1) Sensor-Standby: BLAUE LED leuchtet
(2) Besucher, die sich in 10 cm dem Sensor näherten: ROTE LED AN

MehrFotos



udohow.en.alibaba.com



LED Indicator



A: Black/PC Lens
B: Round Shape LED Indicator

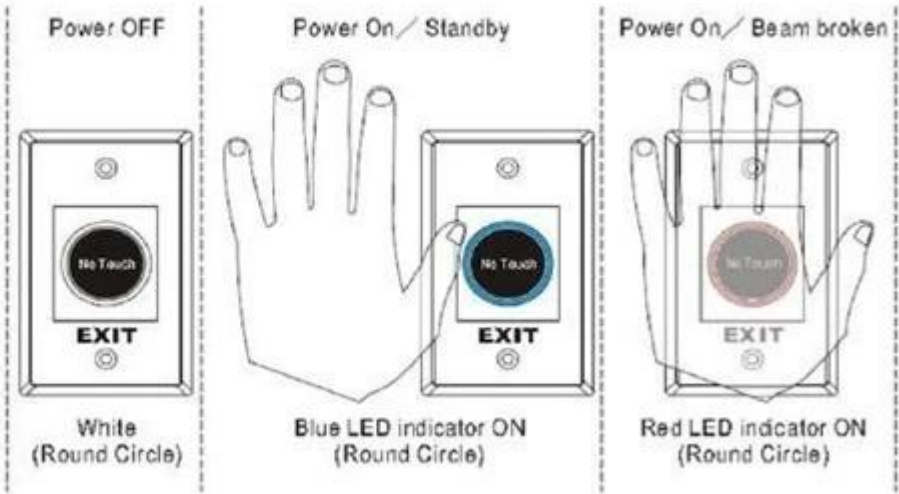

Sensing Range

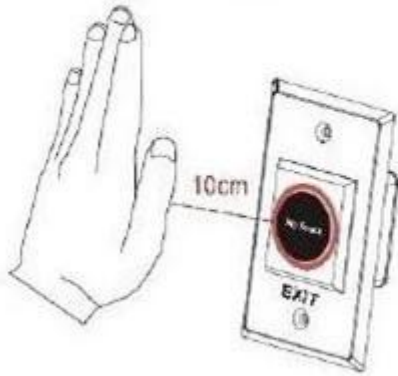

Installation

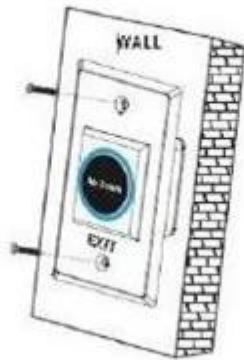

Red LED Indicator:
Power ON (Standby)



Green LED Indicator:
Power ON (Triggered)



Blue LED Indicator:
Power ON (Standby)



Red LED Indicator:
Power ON (Triggered)



Unsere Unternehmen

ABOUT US COMPANY INTRODUCTION

UDOHOW Electronics Co., Limited is a high-tech enterprise located in Guangdong Province, China. We're one of the leading manufacturers specialized in Intelligent Locks and Access Control Products including: Hotel Locks, Fingerprint Locks, Keypad Locks, Cabinets Locks, Electric Locks, Exit Switches and other related security access control products.

Our products have received good comments and trust of customers by superior quality, advanced innovation and considerate service.

[+ View More](#)



FACTORY / WORKSHOP / EXHIBITION



Unsere Zertifikate

OUR CERTIFICATE



Kontaktiere uns

CONTACT US



Sincerely for your service

You are welcome to come to consult

Contact: Winnie Liang

Cellphone/Wechat/Whatsapp: +86 13602510930

Skype: udohow1

Email: info@udohow.com

Web: www.udohow.com

Click Back Home