

Quality DH8805

DH8805

1.25KG

> 40mm



How to change code of the 2th Generation lock

- 1.find the dot on the circle
- 2.Turn the dot toward the number
for example 14569,just turn the dot to the number 14569
- 3.The new code is 14569



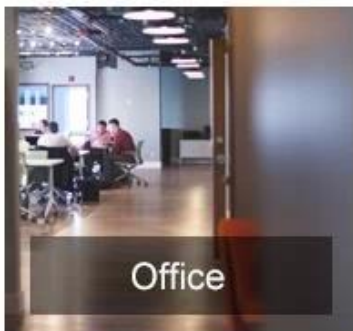

Attribute	Value
Material	Zinc alloy
password type	4-7 number
Appearance	pearl chrome, imitation
Door depth	30-70mm
Application scope	wooden doors, metal doors
Size	142*42*21mm
Working temperature	-20°C - 60°C
Working humidity	0%-95%



Scope Of Application

Official Accessories

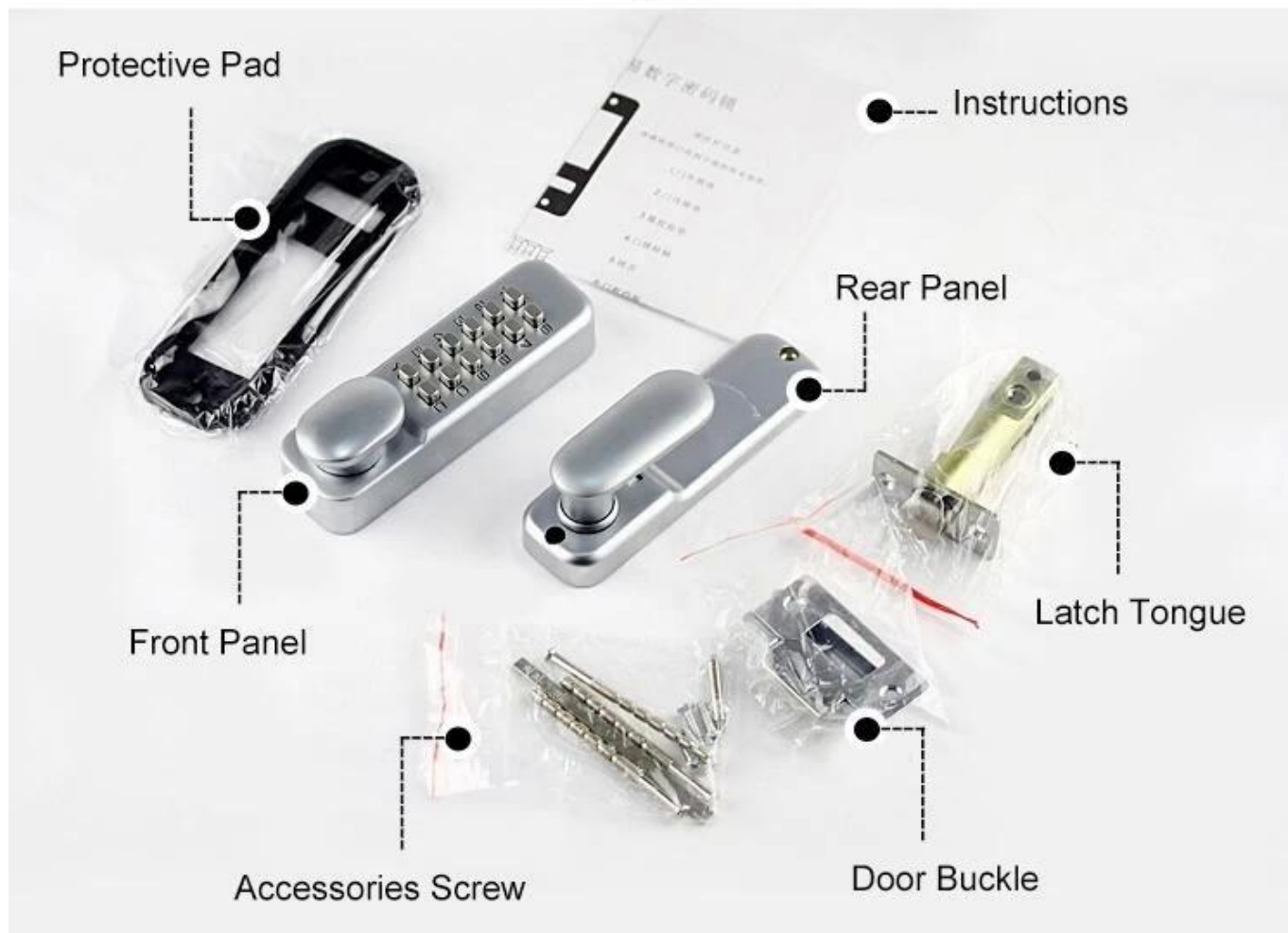

CONTACT US



Sincerely for your service

You are welcome to come to consult

Contact: Winnie Liang

Cellphone/Wechat/Whatsapp: +86 13602510930

Skype: udohow1

Email: info@udohow.com

Web: www.udohow.com

Click Back Home